

OPEL SPEEDSTER / VAUXHALL VX220

COMPONENT INTERNAL AND EXTERNAL



VISIT US ON
facebook

www.Eltech-Italia.com

ELTECH
MOTORSPORT EQUIPMENT

ELTECH-ITALIA

eltech.italia@gmail.com

INTERNAL / INTERNI



-INSERTI CRUSCOTTO
-DASH INSERTS FLAT

CUSTOMIZED
190€

0,1 Kg



-TUNNEL CAMBIO
-GEAR TUNNEL

295€

0,4 Kg



-PANNELLI PORTA
-DOOR PANELS

215€

0,3 Kg



-INSERTI MANIGLIA
-HANDLE INSERT

140€

0,1 Kg



-TUNNEL FRONTALE
-FRONT TUNNEL

195€

0,2 Kg



-SUPPORTO STACK
-STACK SUPPORT

195€

0,3 Kg

INTERNAL / INTERNI



-COVER STERZO
-STEERING COVER
240€

0,3 Kg



-COVER VOLANTE
-REAR WHEEL COVER
135€

0,1 Kg

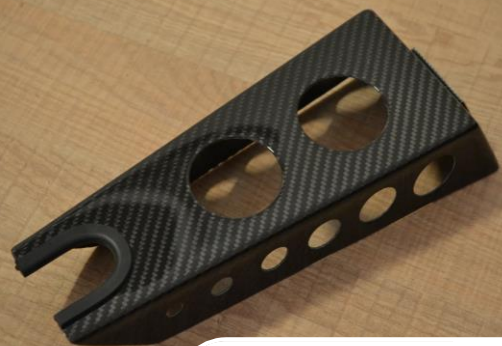

-PORTA MANOMETRI
-UPDATE INSTRUMENT

CARBON
120€
ALLUMINIO
80€

0,1 Kg



-TASCHE DOCUMENTI
-DOCUMENT POCKET
110€

0,1 Kg

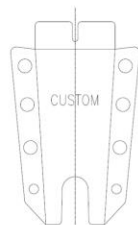
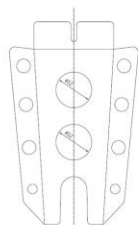
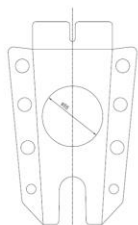
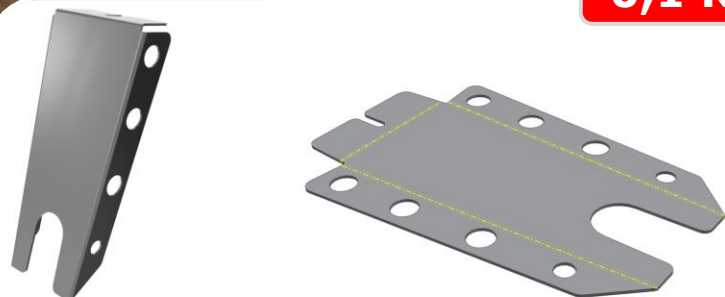

-PORTA BIBITE
-DRINK HOLDER
165€

0,3 Kg

INTERNAL / INTERNI

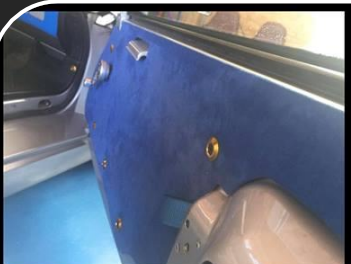

-PANNELLI PORTA RACE
-DOOR PANEL RACE

240€

CARBON
290€

0,3 Kg



-CORNICE TUNNEL CAMBIO
-COVER GEAR TUNNEL

95€

0,2 Kg



INTERNAL / INTERNI



-DISTANZIALI VOLANTE
-SPACER FOR WHEEL

TICKNES 8mm FOR
ALUMINIUM SPACER

24€

0,1 Kg



-COVER ANELLO AIR BAG
-RING COVER AIR BAG

CARBON

150€

0,2 Kg



-ALLUMINIO PER
CONVERSIONE GUIDA
-CONVERSION DRIVE
ALUMINIUM

450€

1,2 Kg

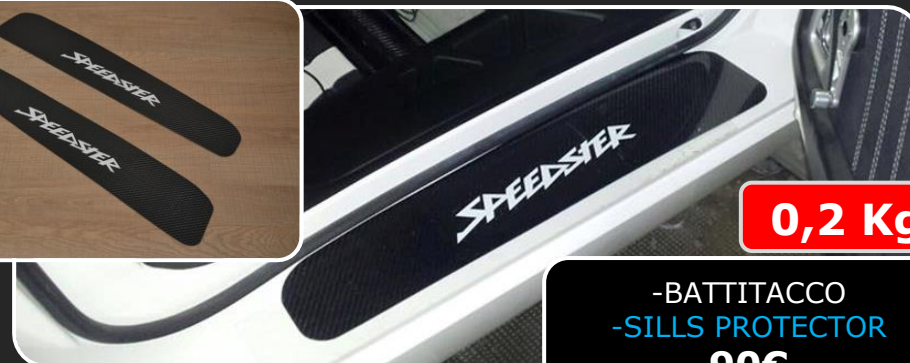
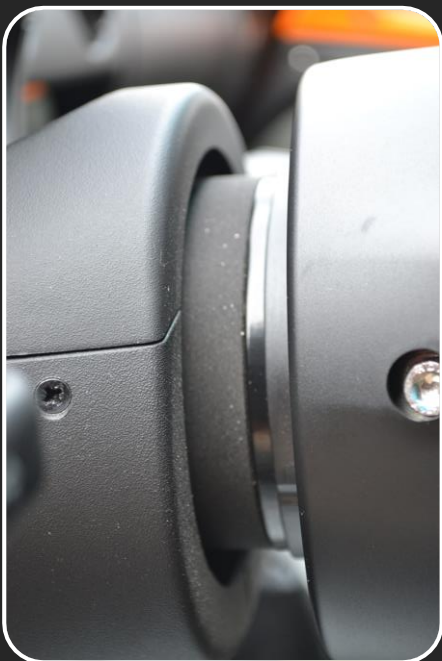

0,2 Kg

-BATTITACCO
-SILLS PROTECTOR

90€

EXTERIOR / ESTERNI

REAR DIFFUSER / ESTRATTORE POSTERIORE

- ALLUMINIO SERIE 7000
- VERNICIATO A POLVERE MOLTO RESISTENTE
- COLORE NERO SU RICHIESTA QUALSIASI

- ALUMINUM SERIES 7000
- PAINT POWDER VERY RESISTANT
- COLOR BLACK OR CUSTOM COLOR ON REQUEST



-ESTRATTORE STRADA
-DIFFUSER STREET
255€

2,4 Kg



-ESTRATTORE RACING
-DIFFUSER RACING
285€

2,7 Kg



EXTERIOR / ESTERNI

REAR DIFFUSER / ESTRATTORE POSTERIORE

- ALLUMINIO SERIE 7000
- VERNICIATO A POLVERE MOLTO RESISTENTE
- COLORE NERO SU RICHIESTA QUALSIASI
- ALUMINUM SERIES 7000
- PAINT POWDER VERY RESISTANT
- COLOR BLACK OR CUSTOM COLOR ON REQUEST

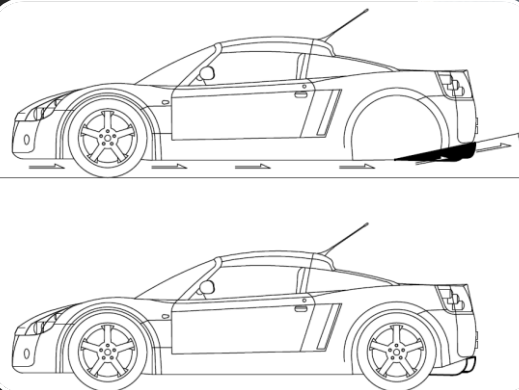

- ESTRATTORE STRADA
5 ELEMENTI
- DIFFUSER STREET 5
ELEMENT
- 290€**

2,7 Kg

- ESTRATTORE STRADA
CARBONIO
- DIFFUSER STREET
CARBON
- 335€**

2,1 Kg



EXTERIOR / ESTERNI

-ESTRATTORE SU DISEGNO
-REAR DIFFUSER CUSTOM DESIGN

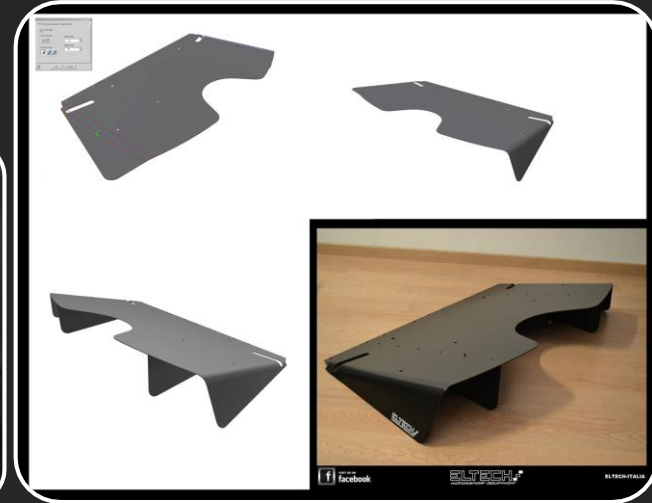

-ESTRATTORE STRADA
SU MISURA
-DIFFUSER STREET ON
REQUEST
295€

2,2 Kg



EXTERIOR / ESTERNI



-COVER SPECCHIETTI
-MIRROR COVER
140€

0,1 Kg

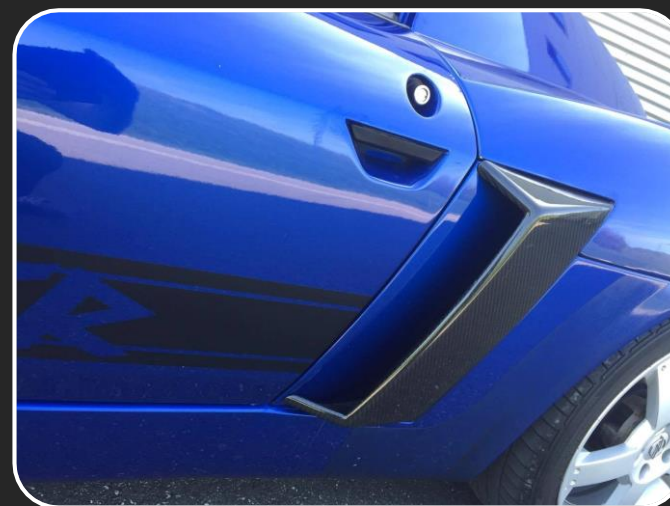

-SPOILER MAXI TURBO
-REAR SPOILER MAXI
330€

1,4 Kg



-PRESE ARIA N/A
-SIDE SCOOP N/A
FIBERGLASS
210€

0,4 Kg



REAR SPOILER TURBO



REAR SPOILER MAXI



-PRESE ARIA N/A
-SIDE SCOOP N/A
CARBON
295€

0,2 Kg

EXTERIOR / ESTERNI

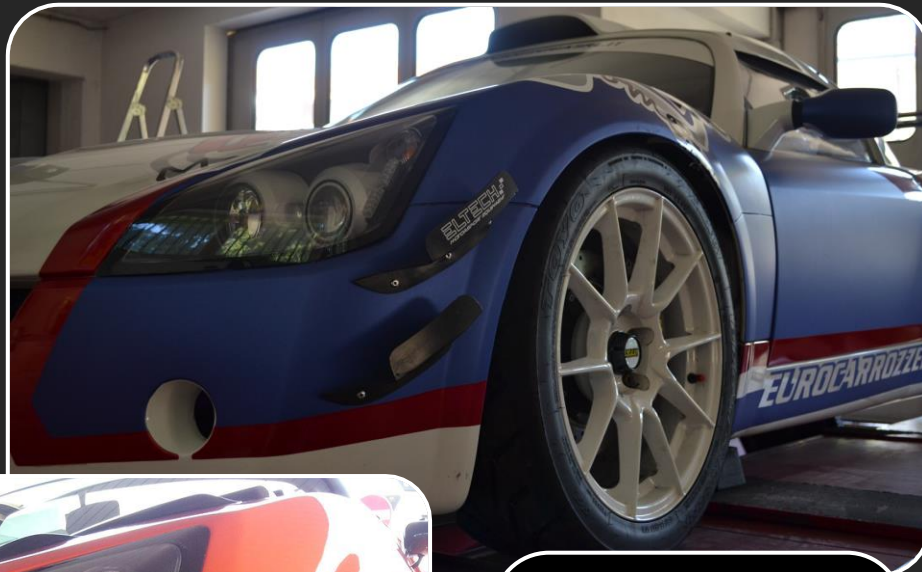

-COVER VASCHETTA
-TANK LIQUID COVER
90€

0,1 Kg



-CANARDS DUE
-CANARDS TWO

FIBERGLASS
110€

CARBON
210€



-COVER SCARICO
-COVER EXHAUST

ALUMINUM PAINT
40€

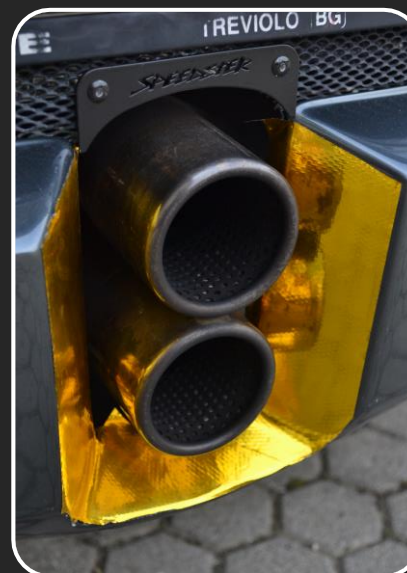

EXTERIOR / ESTERNI

-EGR COPERCHIO
-EGR CAP
22€

0,2 Kg

-PROTEZIONE
RADIATORE ED
ESTRAZIONE ARIA
CALDA

-RADIATOR
PROTECTION FOR
EXTRACTION
HOT AIR
120€

0,4 Kg

-KIT SUPPORTI
ALETTONE SPEEDSTER
-KIT WING SUPPORT
SPEEDSTER

ALU MAGNESIUM
FIX ON SUBFRAME
290€

1,9 Kg



EXTERIOR / ESTERNI



-ALETTONE GT
-GT WING

SIZE CUSTOMED
MAX 1500mm

FIBERGLASS
850€

CARBON
1500€

2,6 Kg

Downforce



Midium Fast Tracks

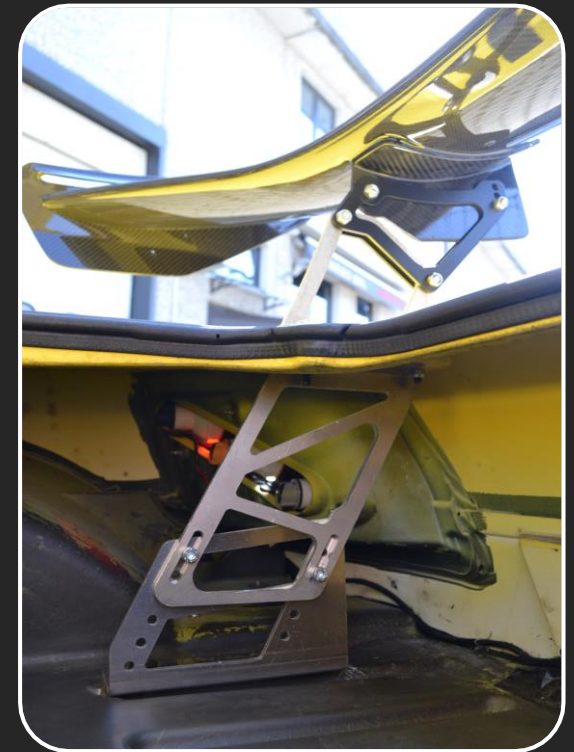

-KIT SUPPORTI
ALETTONE SPEEDSTER
-KIT WING SUPPORT
SPEEDSTER

ALU MAGNESIUM
FIX ON SUBFRAME
FROM 350€

1,9 Kg



-ALETTONE NORMALE
-NORMAL WING

SIZE CUSTOMED
MAX 2000mm

FIBERGLASS
750€

CARBON
1450€

2,2 Kg

Downforce

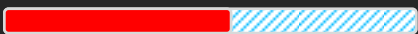

Fast Tracks

Be 183-155		Re=2.57												Xo=2.57		-to=2.7	
		0	5	7.5	10	15	20	30	40	50	60	70	80	90	95	98	100
x%	0	4.26	2.5	1.15	0.59	0.32	0.21	0.15	0.11	0.08	0.06	0.05	0.04	0.03	0.02	0.01	0.01
-Yv	2.32	2.28	2.01	1.39	0.99	0.72	0.54	0.41	0.31	0.23	0.17	0.13	0.1	0.08	0.06	0.05	0.04
Yv	2.32	6.91	9.09	12.36	14.88	16.94	18.76	20.1	22.38	25.09	28.24	31.81	35.78	39.14	41.89	44.03	45.57



EXTERIOR / ESTERNI

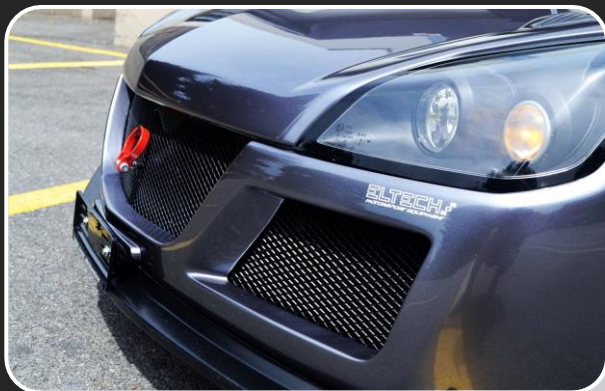

-PRESE PASSARUOTA
-LOUVER BONNET

FIBERGLASS
290€

CARBON
350€

0,2 Kg



-PRESE ARIA FRONTALI
-FRONT AIR SCOOP

FIBERGLASS
180€

CARBON
250€

0,3 Kg



EXTERIOR / ESTERNI



-MANIGLIE ESTERNE
-EXTERIOR HANDLE

98€

0,2 Kg



-SUPPORTO SPECCHIO
-MIRROR SUPPORT

95€ PAIR

0,2 Kg

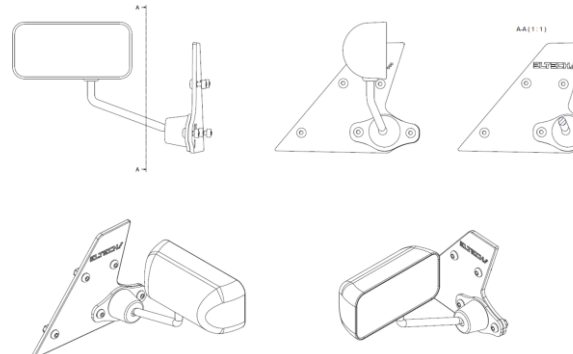

-SPECCHI FORMULA
-MIRROR FORMULA

FIBERGLASS
150€ PAIR

CARBON
300€ PAIR

0,3 Kg



facebook

ELTECH
MOTORSPORT EQUIPMENT

ELTECH-ITALIA



EXTERIOR / ESTERNI



-SPLITTER ANTERIORE
-FRONT SPLITTER

FIBERGLASS BLACK
380€

1,8 Kg



-SPLITTER ANTERIORE
-FRONT SPLITTER

CARBON
480€

1,2 Kg



EXTERIOR / ESTERNI

-LIP ANTERIORE
-ADDITIONAL FRONT LIP

FIBERGLASS BLACK
220€

2,8 Kg



SIDE SKIRTS / MINIGONNE

-MINIGONNE FLAT
-SIDE SKIRTS FLAT

FIBERGLASS BLACK
290€

FIBERGLASS NO PAINT
200€

2,1 Kg



-MINIGONNE FLAT
-SIDE SKIRTS FLAT

CARBON AND
FIBERGLASS
340€

1,8 Kg



BIG SIDE SKIRTS / MINIGONNE MAGGIORATE

-MINIGONNE BIG
-SIDE SKIRTS BIG

FIBERGLASS BLACK

360€

CARBON

395€

2,1 Kg



HARD TOP

HARD TOP FIBERGLASS

- GUARNIZIONI LOTUS ORIGINALI / RUBBER LOTUS OEM
- STAFFE ATTACCO ORIGINALI / BRACKET FIX OEM
- VERNICIATO IN NERO / PAINT IN BLACK

990€

7,0 Kg

HARD TOP CARBON

- GUARNIZIONI LOTUS ORIGINALI / RUBBER LOTUS OEM
- STAFFE ATTACCO ORIGINALI / BRACKET FIX OEM

1400€

5,8 Kg



HARD TOP

HARD TOP CARBON / FIBERGLASS LIGHT RACING

- GUARNIZIONI LOTUS ORIGINALI / RUBBER LOTUS OEM
- STAFFE ATTACCO ORIGINALI / BRACKET FIX LIGHT OEM
- GREZZO / NO PAINT

990€

4,8 Kg



REAR BONNET COUPE'

REAR BONNET COVER ENGINE COUPE'

- BAULE COUPE' STYLE CARBONIO O VETRORESINA
- ENGINE COVER COUPE' STYLE CARBON AND FIBERGLASS

4,8 Kg



REAR BONNET COVER ENGINE COUPE'

VERSION 1 - CARBON + CARBON FLAP	2000€
VERSION 2 - FIBERGLASS + CARBON FLAP	1500€
VERSION 3 - FIBERGLASS + LEXAN BLACK FLAP	1200€
VERSION 4 - FIBERGLASS + FIBERGLASS FLAP	1050€

PLUG AND PLAY
OEM CLOSE SYSTEM

KIT SUPERCHARGED STAGE 2 260CV

Il KIT Eaton M62 è nella versione Stage 2 260cv

Necessario il Radiatore e dual pass
(Intercooler Aria/Acqua).

Kit SC Nuovo 3790€

- Compressore Eaton M62 Stage 2
- Collettori con Laminova con Dual Pass
- Supporto Collettore
- Pompa Acqua
- Cablaggio Iniettori
- Iniettori
- Guarnizioni Varie Gomma
- Guarnizioni Metalliche
- Cinghia
- Staffe Varie e Viteria
- Map Sensor
- Staffa Pulley
- Tubo Gomma per Deviazione Acqua Motore
- Sensori Vari
- Vaschetta Liquido

Kit Chargecooler 300€

- Radiatore Setrab
- Raccordi per Impianto Acqua
- Tubi in Gomma
- 90° Raccordi Silicone
- Raccordo Silicone
- Tubo Metallo Staffe e Viteria



Montaggio del Kit 450€/500€

- Il prezzo può variare in base all'integrità dell'auto
- Montaggio Kit
- Rifacimento Cablaggi Eltrici
- Impianto Chargecooler

Centralina ECU: 1350€

- Programma OBD Tuner 875€
- Spedizione ECU per inserimento Mappa
- Rimappatura Con Programma Specifico personale
- Rullata
- Messa a Punto Centralina

Sono Necessari per il Kit

- Filtro a Cono o Intake
- Scarico Inox con curva da 180° diametro 64mm 2.5"

Spedizione 70€



KIT SUPERCHARGED STAGE 2 260CV

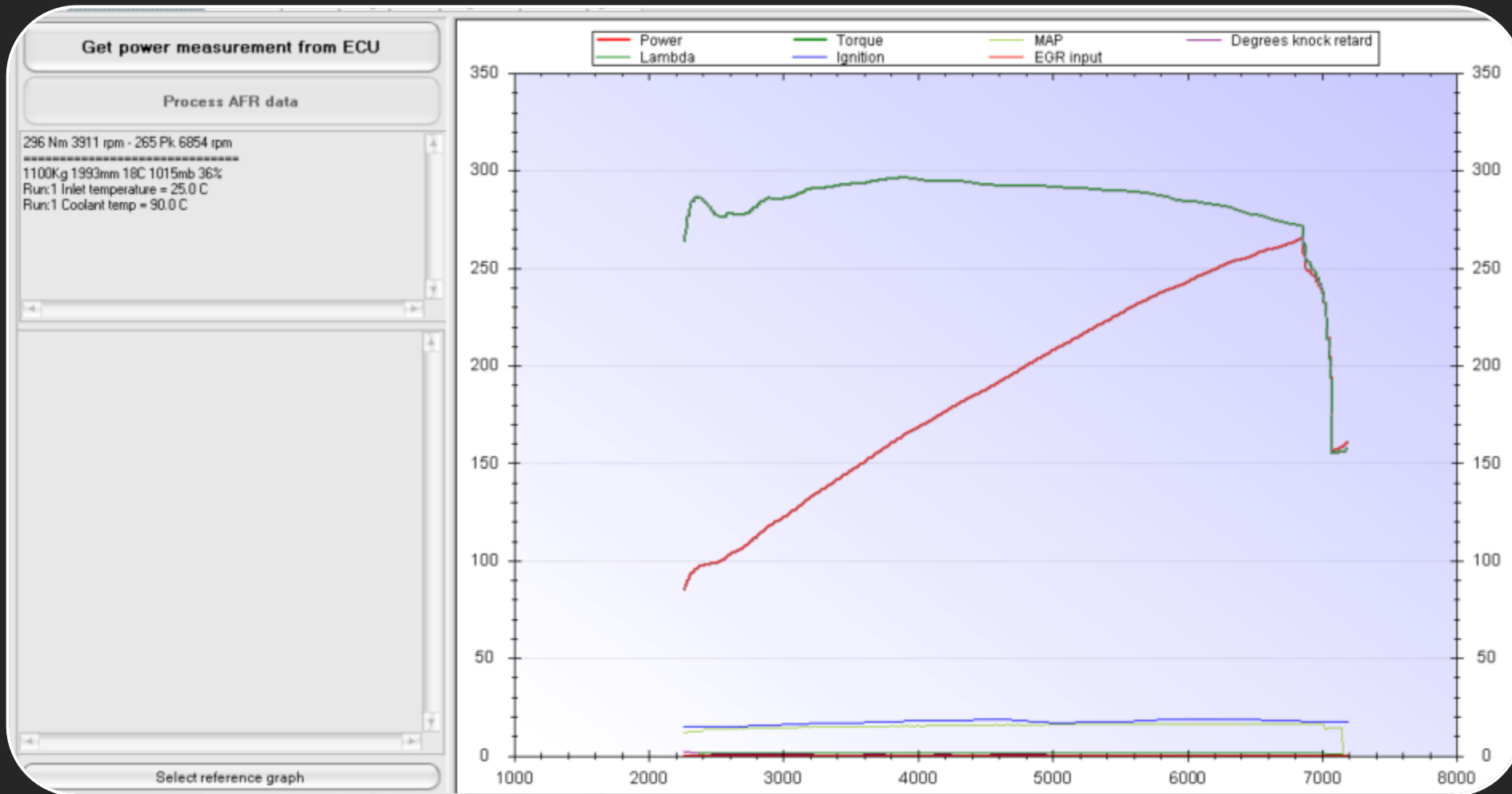

OPEL SPEEDSTER / VAUXHALL VX220

KIT SUPERCHARGED STAGE 2 260CV

